

Vanora park residential complex

Location **Iskele, Long Beach**



About the project



Developer	Uzun Group
Start of sale	01.07.2023
Key handover	2025
Houses/blocks	7
Building floor	10 Min 10 Max
Units total	123 - 2+1, 55 - 3+1

Distance to the sea - 2050 m
 Distance to key locations:
 In 10 minutes the center of Famagusta and the country's largest university, EMU. Airport 45 min. Supermarket 1 min. Pharmacy 1 min. School 7 min. Kindergarten 5 min. Hospital 4 min.

Vanora Park Long Beach, located in one of the most beautiful places in Iskele, is waiting for you to enjoy Cyprus with all your senses. Vanora Park Long Beach consists of 180 units (2 and 3 bedroom options) and also a number of commercial units. Here you will experience the comfort of a hotel from the comfort of home, enjoying closeness to nature with its specially landscaped large garden, admiring a unique sunset from your terrace.

Complex infrastructure

- Café
- Central satellite
- Open pool
- Parking
- Shops

Available units **66** / 183 total

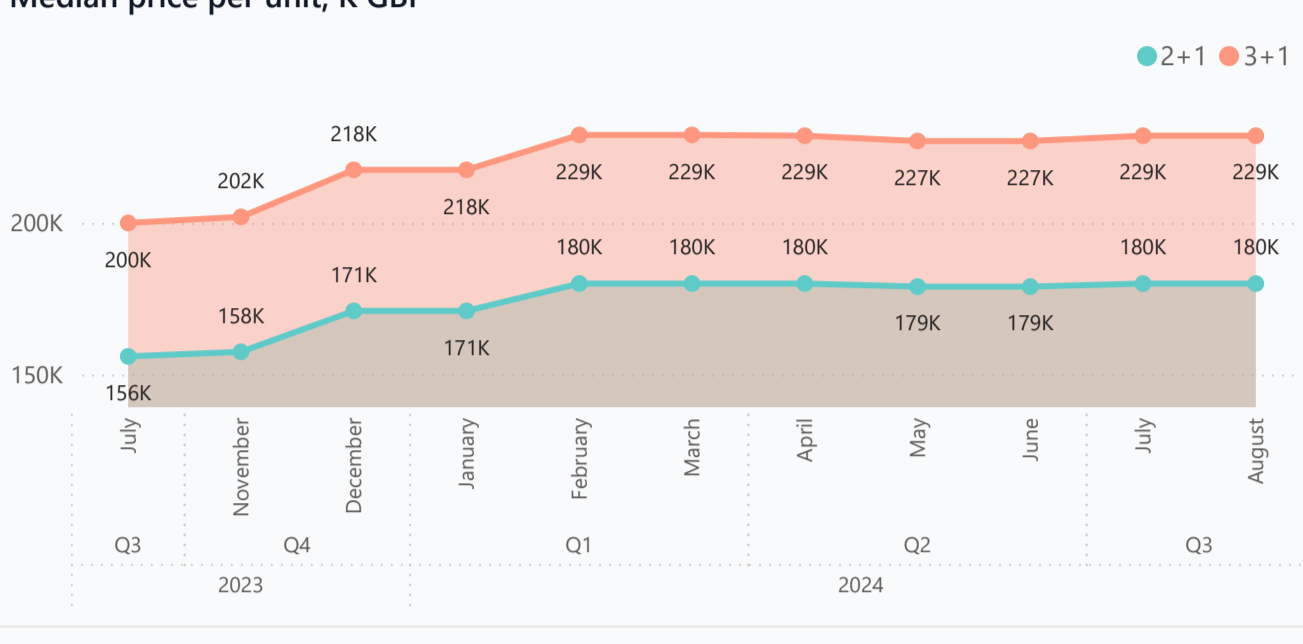

Structure of available units

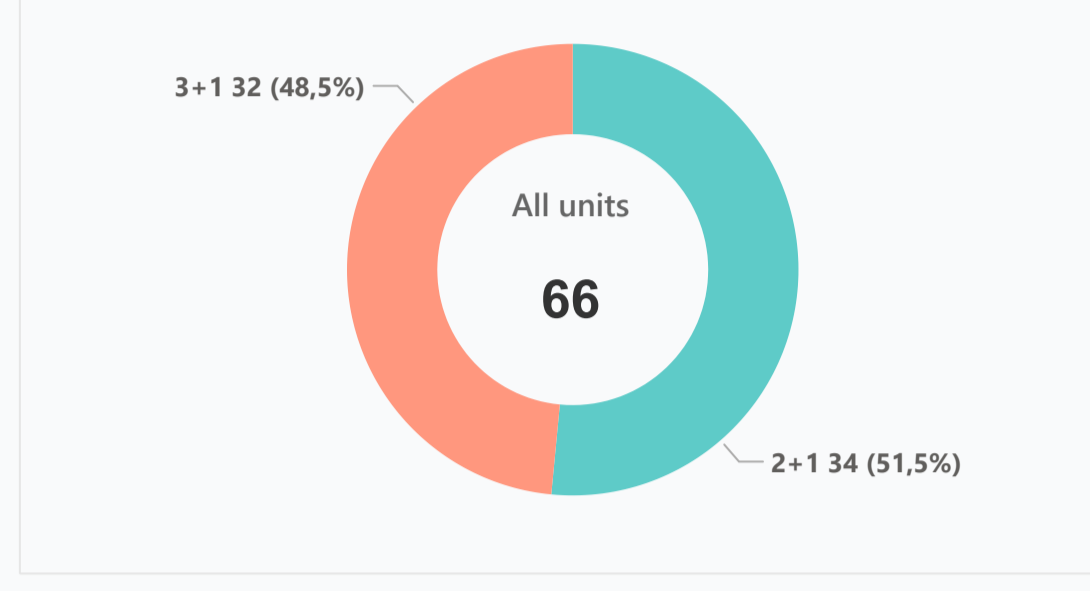

Plans

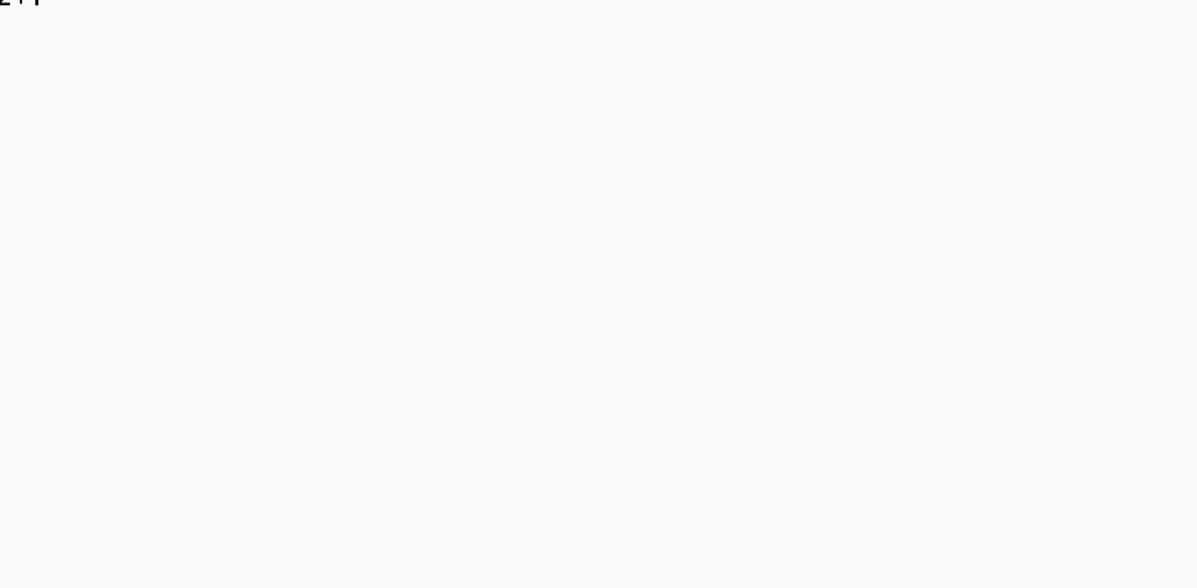

2+1

BLOCK B, 2nd. / 7th FLOOR
Flat 19
Flat 20
Flat 21

AREA:
104 M²
78 M²
75 M²

3+1

Payment plans

Deposit (non-refundable) 5000 GBP

Option	Down payment	Installments months	Discount	Offer
Option 1	40 %	30% till key, 30%...	-	-
Option 2	-	-	-	-
Option 3	-	-	-	-
Option 4	-	-	-	-

Special offer

- Fully furnished design package
- Rental guarantee

Trafo 2000 GBP

Resale after 50%

Maintenance fee -

Rental services -

Details

Bedrooms	Subtype	Block	Unit №	Floor	View	Bathroom	Internal area, sq. m	Balcony/ Terrace, sq. m	Rooftop terrace, sq. m	Garden, sq. m	Gross covered area, sq. m	Current price, GBP	Price per sqm, GBP
2+1	Flat	B2	F18	06		1	75	8			83	180 000	2 169
2+1	Flat	B3	F25	09		1	100	59			159	325 500	2 047
2+1	Flat	B4	F6	02		1	75	8			83	175 000	2 108
2+1	Flat	B4	F11	04		1	78	9			87	178 000	2 046
2+1	Flat	B4	F18	06		1	75	8			83	178 500	2 151
2+1	Flat	B4	F17	06		1	78	9			87	179 500	2 063
2+1	Flat	B4	F21	07		1	75	8			83	179 500	2 163
2+1	Flat	B4	F24	08		1	75	8			83	182 500	2 199
2+1	Flat	B4	F25	09		1	100	59			159	325 500	2 047
2+1	Flat	B5	F3	01		1	78	11			89	178 000	2 000
2+1	Flat	B5	F6	02		1	75	8			83	176 000	2 120
2+1	Flat	B5	F12	04		1	75	8			83	176 500	2 127
2+1	Flat	B5	F14	05		1	78	9			87	178 500	2 052
2+1	Flat	B5	F18	06		1	75	8			83	178 500	2 151
2+1	Flat	B5	F24	08		1	75	8			83	182 500	2 199
2+1	Flat	B5	F25	09		1	100	59			159	325 500	2 047
3+1	Flat	A	F7	03		1	104	9			113	257 500	2 279
3+1	Flat	A	F10	04		1	104	9			113	258 500	2 288
3+1	Flat	A	F16	06		1	104	9			113	260 000	2 301
3+1	Flat	A	F19	07		1	104	9			113	262 500	2 323
3+1	Flat	A	F22	08		1	104	9			113	265 000	2 345
3+1	Flat	B1	F1	01		1	104	9			113	223 000	1 973
3+1	Flat	B1	F10	04		1	104	9			113	224 500	1 987
3+1	Flat	B1	F16	06		1	104	9			113	226 500	2 004
3+1	Flat	B1	F19	07		1	104	9			113	227 500	2 013
3+1	Flat	B2	F1	01		1	104	9			113	223 000	1 973
3+1	Flat	B2	F4	02		1	104	9			113	223 500	1 978
3+1	Flat	B2	F10	04		1	104	9			113	227 000	2 009

Interior specification



Interior specification

- Ceramic flooring
- Double glazed windows
- Fitted wardrobes in each bedroom
- Laminate flooring in the bedrooms

Exterior specification

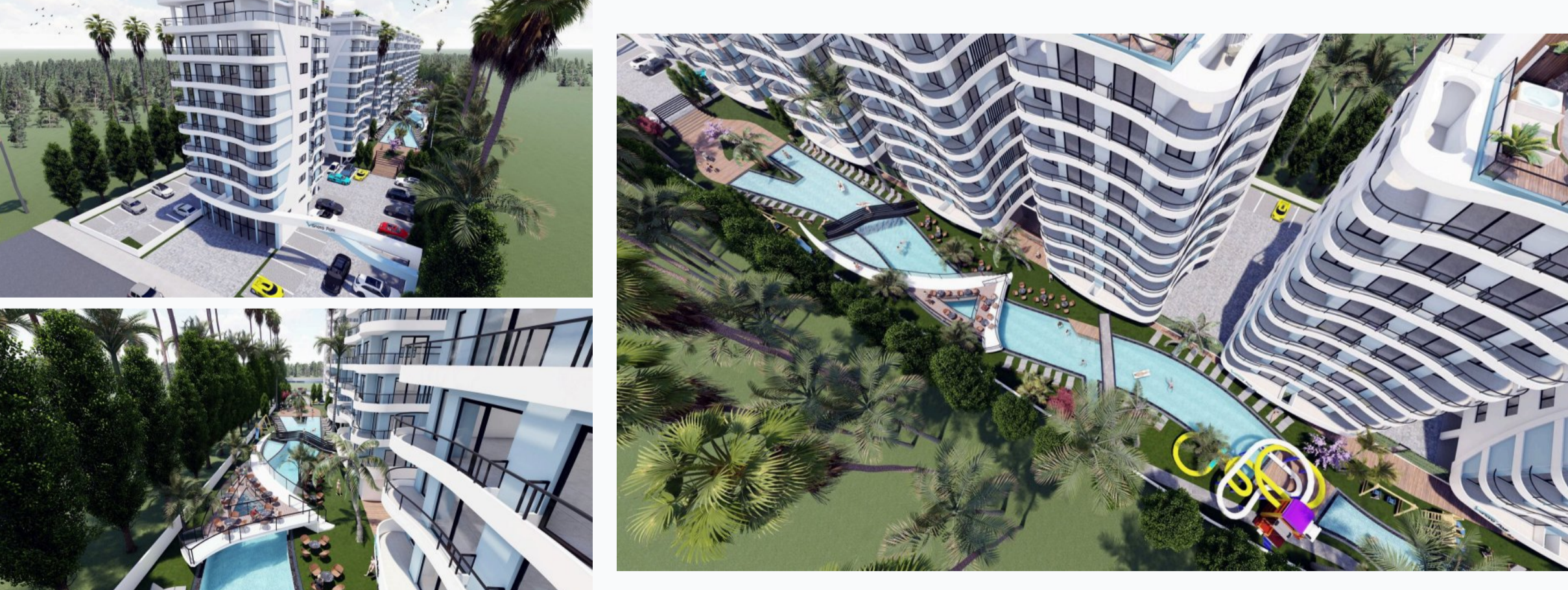

Exterior specification

- Glass fence balcony

Location of complex

